

1. The Farmstead

Carl Linnaeus bought Hammarby in 1758. Until his death in 1778, he and his family spent the summers here and Linnaeus received many visitors. The family stayed in Uppsala in the wintertime while two tenant farmers ran the farm. Following the death of Linnaeus, his widow, Sara-Lisa moved to the farm and ran the operations to sustain her family. Linnaeus built the main building and it looks the same to this day.

2. Orchard

The orchard, left of the footpath, is a gene bank for preserving old varieties of apple. The technique of grafting varieties of apple onto hardy stocks was spread in Sweden in the early Middle Ages. This allowed for the cultivation of bigger and tastier apples and eventually the apple tree became common. In Linnaeus' days there was probably a cabbage patch in the area.

3. Pollards

In the 18th century there were plenty of pollards at Hammarby. To illustrate what it might have looked like, the trees on this slope are newly lopped. Lopping means harvesting foliage, twigs and small branches from trees, with a few years' interval. The twigs were dried and given to the animals during wintertime. With time, trees become important habitats for insects, fungi and lichen.

4. The Kronoparken Park

Here the footpath runs past two house foundations. In the one on the right (eastern) there are remains of a fireplace; it was possibly a smithy. In Linnaeus' days, these woods were a so-called 'kronopark', a state-owned forest used as hunting grounds. If the farmers needed wood or fencing timber, they had to buy it from elsewhere. However, the farms around the Kronoparken did have the right to let their livestock graze in the area. Eventually, the Crown's interest in hunting waned, although the Kronoparken remained for a long time.

5. Ryttaarvreten and the Soldier Cottage

The small farming field was in Linnaeus' days called 'Ryttaarvreten'. Today, parts of the field are farmed using 18th century methods, and let to lie fallow every other year. When crops were grown, the animals were kept off the fields, but in the fallow years, they were allowed in to graze on the weeds. 'Ryttare' means horse-man and 'vret' means a small fenced arable land.



Five stone boundary marker

6. The Vantage Point

The surrounding forest will be gradually more maintained using old methods and will have a great variety in age and types of trees. In the 18th century the trees were felled by axe. The stumps were then taller than today's. The forest was also used for pasture.

7. 'Femstenarör'—The 'five stone boundary marker'

There were several ways to mark the boundaries between properties. Here the boundary between Hammarby the Crown Park and Ångeby is marked with a 'femstenarör'. In the centre is a large pointer stone surrounded by four smaller stones. It is likely to originate from an 1803 boundary survey. There are several similar boundary markers in the area.

8. Ångebyvägen

Here the cultural pathway joins the road, which in Linnaeus' days ran between Hammarby and Ångeby, and on to the parish church. The road is marked on maps from the mid 1600s, but it is likely to be much older. Linnaeus probably walked this road many times.

9. Detailing the view

The cultural pathway runs past the wooden fence and into Hammarby's arable land and fields. The sign provides information on Linnaeus' botanical excursions in the Uppsala region. The footpath follows the old ditch system to a wooded hillock.

10. Gastholmen

In Linnaeus' days the hill lay like an island in the fields. On the little hill there is a burial ground with more than 20 stone monuments dating from the Iron Age. It is likely that this gave Gastholmen its name—'Ghost Island'. The hill has also been called 'Galgbacken'—'Gallows Hill', as it was mistakenly thought to be an execution ground. There was however a documented execution ground on the Mora commons, two kilometres south, on the border of the judicial districts of Långhundra and Vaksala. It was used in Linnaeus' times.

11. The Purple Willow

Linnaeus was the first to describe the Purple Willow and he wrote that the plant was suitable for binding sheaves of grain and thatching, as well as for basket making. It was planted here in 1772 and Linnaeus recommended his visitors also to grow the plant. In springtime, willows are of great importance to bees, wild and domestic, as they flower in a period when there is otherwise a shortage of nectar.

12. The road to Edeby

The road to Edeby links Hammarby to the old Stockholm road. The initiative to build the road came from Linnaeus himself. The journey to Stockholm was made considerably shorter. Here there was a gate in the fence that protected the growing crops in the field. On either side of the road, an ash tree was planted. In 2004, ashes were again planted here.

13. The Calf Paddock

In the 18th century, it was common to keep a small grazing paddock next to the farm for calves and other small livestock. Here the fence runs along the same stretch as when Linnaeus bought the farm. To the south, a faint terraced edge shows the divide between Hammarby's and Edeby's arable fields. By farming only half of the field each year, harvests were sustained despite shortage of manure, although the harvests were modest.



Two-field fencing

14. The landscape scene

The moist grounds next to the Sävjaån creek were hayfields and pastures. Further upland, they could drain the ground with ditches, making it suitable for growing barley or rye. The arable land and hay meadows were protected from the grazing animals by a fence. Buildings were placed where the fertile clay soil and the stony moraine meet. The livestock usually wandered freely in the woods.

15. The traditional wooden fence

This type of split rail fence consists of upright stakes with diagonal rails. The maintenance of long stretches of fencing was very time-consuming. In spring, before the animals were let out to pasture, the fences were inspected. The fences were there to keep the livestock away from crops and were not general boundaries of lands.

16. Future hop garden

In the 17th and 18th century, Hammarby's hop garden was located between Tjockstavägen and the rocks. Hops were used as a preservative when making beer, just as salt was used in preserving meat and fish. Starting in the 15th century, every farmer was obligated by law to grow hops, with the aim of making the country as self-sufficient as possible. The hop garden will be restored in 2009 using clones of the old Uppland hops taken from the Nordic Gene Bank in Julita.

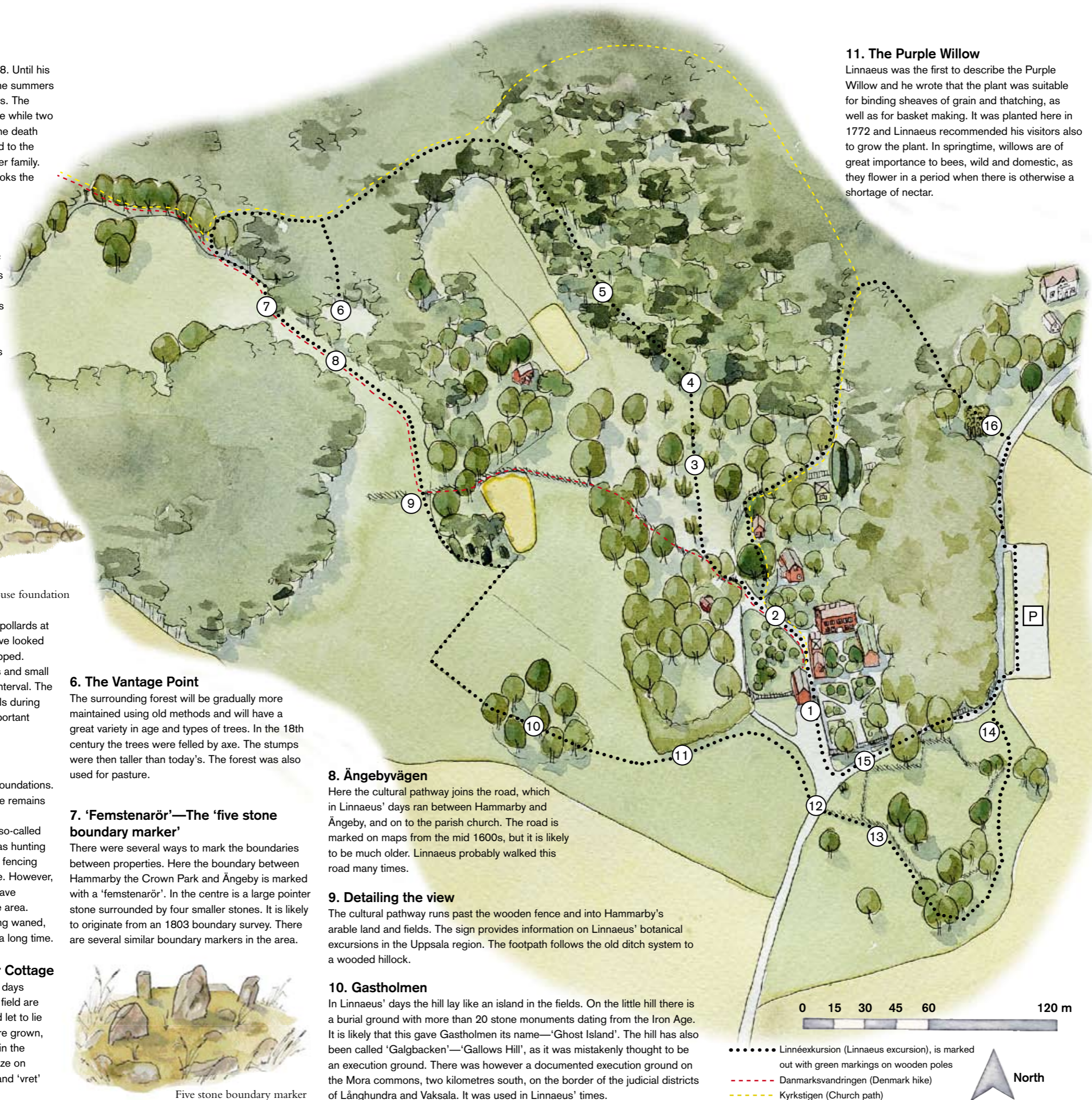

..... Linnéxkursjon (Linnaeus excursion), is marked out with green markings on wooden poles
- - - - - Danmarksvandringen (Denmark hike)
- - - - - Kyrkstigen (Church path)